

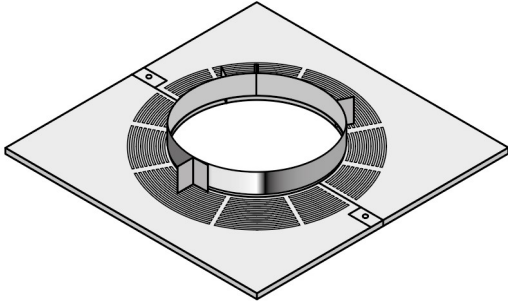

Square Support Ventilated



PRODUCT DESCRIPTION

SuppPltSqVent100 150/2pc/3,0/-/GV/PMSA25



[Sirius stove brochure](#) [Download](#)



[Sirius stove operating manual](#) [Download](#)



[Protect Box installation instructions](#) [Download](#)



[Perimeter Smooth Air DOPs and certificates](#) [Download](#)

The Perimeter Smooth Air Chimney System provided with the Sirius stove is a steel chimney with air supply offers great flexibility and flexible placement.

All Sirius models are approved by the highest European standards for air independent use. This allows the combined usage with ventilation systems in modern buildings and guarantees a healthy indoor environment.

Schiedel Perimeter Smooth Air chimney is constructed with a separate inlet-duct ensuring that the stove is supplied with the optimal amount of combustion air from the top of the pipe. The double insulated pipes avoid condensation.

**Product description**

Product description	Modular, concentric flue system for operation with room sealed Wood appliances with continuous operating temperature up to 600 °C.
Installation	Inside a building
Fuel	Wood
Operating temperature	≤ 600 °C
Mode of operation	- negative pressure (N1 ≤ 40 Pa) - dry
Inner pipe material	EN 1.4404 (AISI 316L)
Outer case material	- galvanized steel, powder painted - 1.4301 (304) stainless steel
Outer case finish	- black (RAL 9005)
Insulation type	PMSA 25: 25 mm thick mineral wool tube, with aluminium lamination.
Insulation density	128 kg/m <sup>3</sup>



Thermal resistance	PMSA 25 = 0,37 m <sup>2</sup> K/W
Mean roughness	1,0 mm according to EN 13384-1
Height above last structural support	Max free standing height is 2m. Where height is >600mm above the last structural support, a locking band is required immediately below the roof support and on any pipe joints above it.
Distance between lateral supports	3,0 m

**CE Certificate number EN 1856-1: CE Designation EN 1856-1:**

0036 - CPR - 91236 - 034	T400 N1 D V3 L50050 G75 With Ceiling Box and Protect Box with in Bungalow
0036 - CPR - 91236 - 034	T400 N1 D V3 L50050 G100 With Ventilated Firestop Plate in a combustible shaft with combustible floors

**Details**

Internal diameter:	150 mm
External diameter:	250 mm
Inner liner thickness:	0,6 mm
Outer wall thickness:	0,6 mm
Weight:	7,7 kg/m

Type post code or city. Press ENTER Radius:  ▼



-