

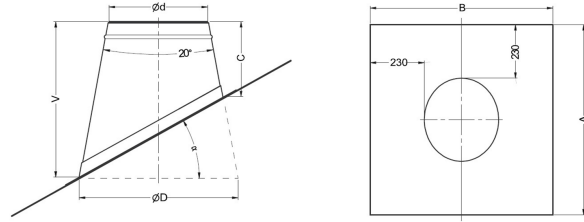

WAKAFLEX 3- 15 DEGREE FLASHING



Lead-free roof flashing, improved for better Health & Safety. WAKAFLEX flashing is a lead-free flashing for roofs to help prevent leaks and is an extremely flexible material, as it can be stretched easily.

It requires no special tools or welding on site and is easy to cut, plus it is lightweight for easy installation. Schiedel WAKAFLEX flashing is a very durable and environmentally friendly product.

Features

- Easy to modify to fit all installation types.
- Easy to handle and install.
- Durable and designed to last.
- Safe design

Benefits

- It is a very light material and is easy to cut.
- There is no welding necessary on site.
- WAKAFLEX is UV resistant.
- Lead free.

VARIATIONS

SKU	Price	O d mm	OD mm	A	B	Colour
148969		300	399	944	784	Black
175252		200	292	837	680	Matt
175253		250	346	890	733	Matt
175254		300	399	944	784	Matt
148967		200	292	837	680	Black
148968		250	346	890	733	Black

PRODUCT DESCRIPTION



The Metaloterm® MF system is a modular twin-wall insulated flue/chimney system, made of stainless steel, with a sealing ring. Metaloterm® MF is a universal flue/chimney system that is suitable for both high and low temperatures, non-condensing and condensing applications with flue gasses in positive and negative pressure. It can resist a chimney fire.

Therefore the system is suited for a wide range of applications such as boilers, stoves and ovens. The product range also contains a wide variety of silencers. For Passive houses, the Metaloterm assortment provides the Iso-block which can be combined with MF. The system can also be used for CHP applications, in this case, a special VITON® sealing ring might be necessary.

Due to the proven quality, Metaloterm® MF has a 10-year guarantee.

APPLICATIONS

- Atmospheric gas-fired boilers
- Condensing boilers
- Wood-fired stoves
- Industrial ovens, large-scale establishments

ADVANTAGES

- Universal chimney/flue system
- Inner- and outer wall from high quality stainless steel
- No terminal bridges, uninterrupted insulation from base plate to top stub
- Stress free thermal expansion
- Fast-build system without the need of sealants
- Compatible with system Metaloterm® ME, UE and EN
- High density and high quality insulation



- High-temperature silicone sealing ring
- Lightweight elements
- Immediately ready for use
- Chimney fire resistant



[UK Plus brochure](#) [Download](#)



[UK Plus Declaration of performance and related docs.](#) [Download](#)

EN 1856-1 System chimney CE Designation:

036 – CPR – 91236-057 Production: Teplice (CZ)

T200 – P1 – W – V2 – L50040 – O00
 T200 – P1 – W – Vm – L20040 – O50
 T600 – N1 – W – V2 – L50040 – O50
 T600 – N1 – W – Vm – L20040 – O50

EN 1856-2 Connecting flue pipe CE Designation:

0036 – CPR – 91236-058 Production: Teplice (CZ)

T200 – P1 – W – V2 – L50040 – O30
 T200 – P1 – W – Vm – L20040 – O30



[Metaloterm MF brochure](#) [Download](#)



[Metaloterm MF DWG files](#) [Download](#)

CE approved | EN 1856-1

T200 P1/H1 W V2 L50040 O10
 T450 N1 W V2 L50040 G60
 T450 N1 D V3 L50040 G60 (Scenario 1: Combustible Floor & Combustible Enclosure)
 T450 N1 W V2 L50040 G60
 T450 N1 D V3 L50040 G50 (Scenario 2: Non combustible Floor and Non Combustible enclosure, or in Free Air)

CE approved | EN 1856-2:

T200 P1/H1 W V2 L50040 O10 M
 T450 N1 W V2 L50040 O40 M
 T450 N1 D V3 L50040 G70 M

* Above CE designations refer to Ø100-300 – For larger diameters refer to Schiedel Metaloterm website.

DECLARATION OF PERFORMANCE / FIRE RATING



MFUE EN
Declaration
of
performance [Download](#)
and related
docs.